

GENERAL NOTES

- (1) THE FOLLOWING OPTIONS MAY BE USED AS THE FIRST ADVANCE WARNING THE MOTORISTS SEES:
 - A. TRUCK MOUNTED ADVANCE WARNING SIGNS
 - B. MOVING CHANGEABLE MESSAGE SIGN (CMS)
 - C. GROUND MOUNTED ADVANCE WARNING SIGNS (MUST USE "NEXT 10 MILES" AND MAKE CIRCLE TO PICK UP SIGNS)
 - D. STATIONARY CHANGEABLE MESSAGE SIGN (CMS) (MUST USE "NEXT 10 MILES" AND MAKE CIRCLE TO PICK UP CMS)
- (2) IF USING GROUND MOUNTED ADVANCE WARNING SIGNS OR STATIONARY CMS THE TOTAL DISTANCE BETWEEN THE FIRST ADVANCE WARNING SIGN OR CMS AND MOWING VEHICLE SHOULD NOT EXCEED 10 MILES AND SHOULD READ "MOWING AHEAD NEXT 10 MILES".
- (3) SIGNS ON VEHICLES SHOULD BE MOUNTED A MINIMUM OF ONE (1) FOOT FROM THE GROUND AND SHOULD NOT BLOCK THE MOTORIST'S SIGHT OF THE LIGHT BAR.
- (4) GROUND MOUNTED SIGNS MUST BE MOUNTED A MINIMUM OF FIVE (5) FEET FROM THE GROUND TO THE BOTTOM OF THE SIGN.
- (5) USE A LIGHT BAR ON TOP OF CAB AND TWO OUTSIDE BLINKING AMBER LIGHTS VISIBLE FROM BOTH DIRECTIONS ON ALL MOWERS.
- (6) USE "CAUTION MOWER" ON REAR OF EACH MOWER.
- (7) MOWING OPERATIONS ARE RESTRICTED TO DAYLIGHT HOURS.
- (8) WHEN TRAVELING FROM ONE SIDE OF A BRIDGE TO ANOTHER, BOTH MOWER AND TRUCK MUST WAIT FOR A BREAK IN TRAFFIC AND MOVE OUT INTO THE TRAVELWAY SIMULTANEOUSLY TO GET TO THE OTHER SIDE.
- (9) USE A TYPE "B" FLASHING ARROW PANEL.
 - PANEL TYPE MIN. SIZE
 - B 60" X 30"
- (10) IF MOWING VEHICLE OR TRUCK MOUNTED IMPACT ATTENUATOR ARE CLOSER THAN 1' TO EDGELINE, MOWING OPERATION DRAWING NUMBER 3 OR 3 MUST BE USED. IF MOWING VEHICLE IS 4' OR MORE FROM EDGELINE, MOWING OPERATION DRAWING NUMBER 1 OF 3 MAY BE USED.

LEGEND

- ▲ CONE
- K PORTABLE SIGN
- ▶ DIRECTION OF TRAFFIC FLOW
- ☐ MOWING VEHICLE WITH LIGHT BAR
- ☐ PROTECTION VEHICLE WITH TRUCK MOUNTED IMPACT ATTENUATOR AND LIGHT BAR (SEE IND NO. 11662.01)
- ◻ FLASHING ARROW PANEL, TYPE "B"
- ◻ CAUTION MOWER

MAY BE SIGNS OR CMS AND EITHER GROUND MOUNTED OR TRUCK MOUNTED

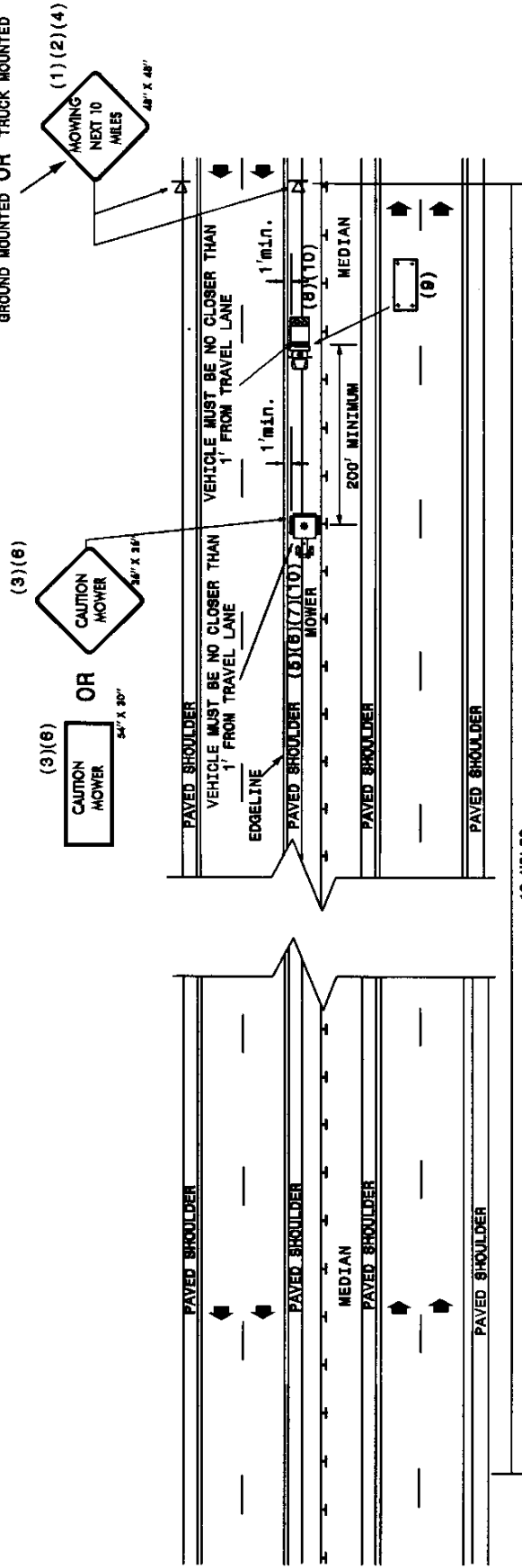

MOWING OPERATION

INTERSTATE AND MULTILANE DIVIDED FACILITIES
 MEDIAN WITH MOWING VEHICLE & TMA LESS THAN FOUR (4) FEET
 BUT NO CLOSER THAN ONE (1) FOOT FROM EDGELINE

LOCATION:

VOLUME:

SPEED:

DRAWING 2 OF 3
 IMPLEMENTATION DATE: 11/05/01
 REVISED: 04/17/02