

# I-306 DURHAM COUNTY

INTERSTATE 85

PROJECT SCHEDULES AND COSTS ARE ACCURATE AS OF DATE SHOWN

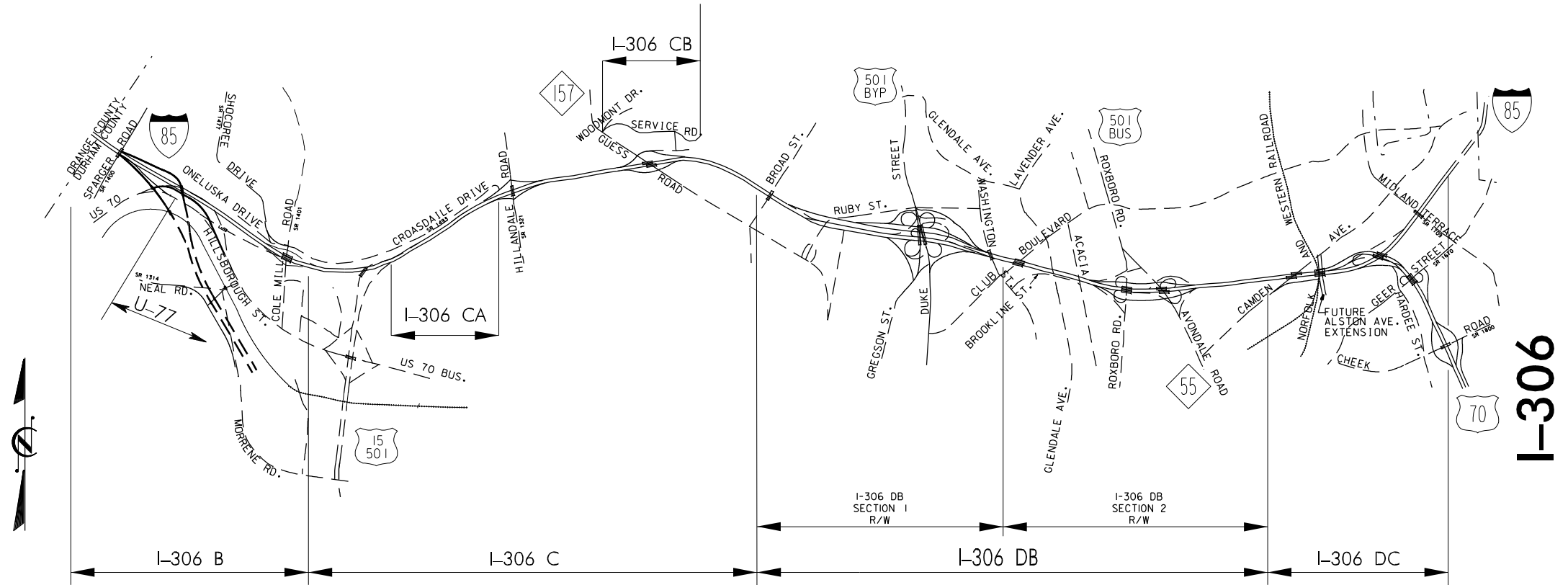

	COMPLETE	LET	COMPLETE	COMPLETE	LET	LET
I.D. NO. / D.S.R. NO.	I-306 B	I-306 C	I-306 CA	I-306 CB	I-306 DB	I-306 DC
STATE PROJECT NO. (P.E.)	8.1414801	8.1414801	8.1414801	8.1414801	8.1414801	8.1414801
PROJECT ENGINEER	ALFORD	ALLEN	DDC (DIV. 5)/MCGEE	ALFORD	ALLEN	ALLEN
PROJECT DESCRIPTION	ORANGE CO. LINE TO E. OF SR 1401 AND US 70 CONNECTOR	EAST OF SR 1401 TO WEST OF BROAD STREET	I-85 WIDENING FROM US 15-501 TO HILLANDALE ROAD	CONSTRUCT SERVICE ROAD IN NE QUADRANT OF GUESS ROAD INTERCHANGE	WEST OF BROAD STREET TO WEST OF CAMDEN AVE.	WEST OF CAMDEN AVE. TO N. OF MIDLAND TERRACE RD. & E. OF CHEEK RD. ON US 70
COUNTY / DIVISION	DURHAM / DIV. 5	DURHAM / DIV. 5	DURHAM / DIV. 5	DURHAM / DIV. 5	DURHAM / DIV. 5	DURHAM / DIV. 5
LENGTH	2.703 ML.	3.0 ML.	0.32 ML.	0.41 ML.	2.3 ML.	1.24 ML.
TYPE OF CONTRACT	TURNKEY	TURNKEY	TURNKEY	TURNKEY	TURNKEY	TURNKEY
REMARKS	RECONSTRUCT I-85, RELOCATE US-70, ADD RAMPS TO SR 1401 INTER.		DIVISION DESIGN PO CONSTRUCTION			I-85 - 1.24 Miles US 70 - 0.8 Miles
BEGIN R/W ACQUISITION (T.I.P.)	9-91	1-01		5-96	SEC. 1 (6-98)/SEC. 2 (11-97)	10-96
BEGIN R/W ACQUISITION (PRODUCTION)						
PROPOSED LETTING (T.I.P.)	9-93	6-03	6-95	2-97	1-01	7-99
PROPOSED LETTING (PRODUCTION)						
EST. COMP. DATE (T.I.P.)	6-99	5-07	12-95	4-98	4-07	2-07
ESTIMATED R/W COST	\$ 1,397,000	\$ 6,200,000	\$ 300,000	\$ 610,000	\$ 8,903,000	\$ 2,500,000
ESTIMATED CONSTRUCTION COST	\$ 25,700,000	\$ 76,600,000	\$ 300,000	\$ 1,400,000	\$ 79,000,000	\$ 64,600,000